

FWC

Aluminum Wheel Chuck

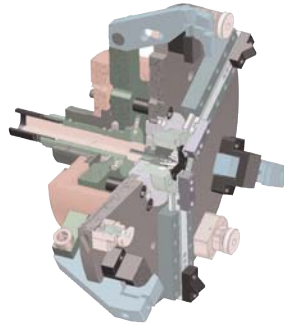

- Ideal for machining aluminum wheels
- Used a Variety of wheels by changing jaws and arms
- Lower weight increases efficiency and reduces down time



APPLICATION CHUCK

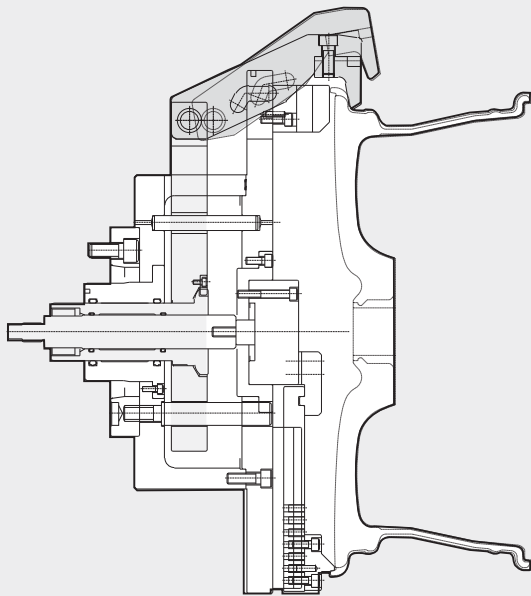

(OP#10)

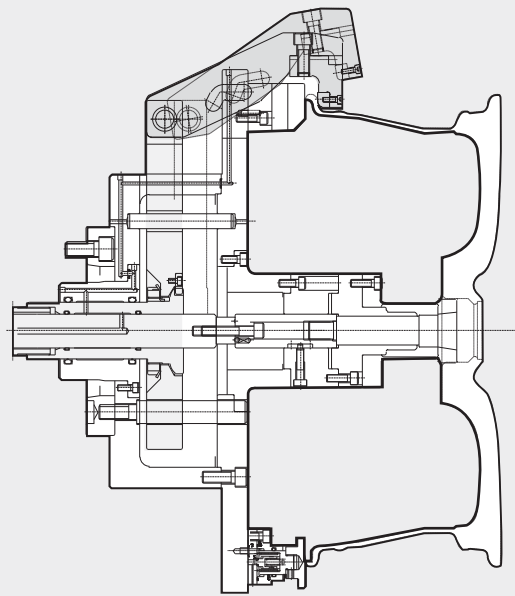

(OP#20)

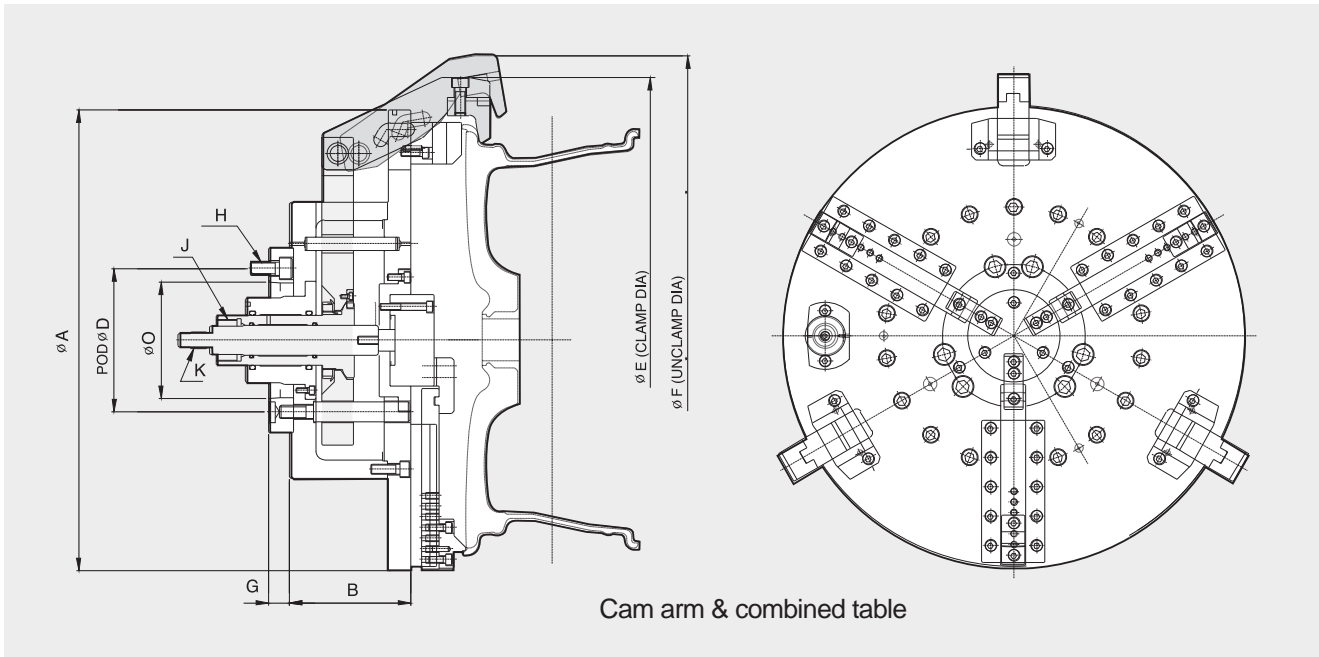

Cam arm & combined table

Cam arm & Combined table

FWC-300					FWC-310						FWC-320			
JAW	Cam Arm				JAW	Cam Arm					JAW	Cam Arm		
	S	M	L	XL		S	M	L	XL	XXL		S	M	L
A	12	13	14	15	A	13	14	15	16	17	A	17	18	19
B	13	14	15	16	B	14	15	16	17	18	B	18	19	20
C	14	15	16	17	C	15	16	17	18	19	C	19	20	21.5
D	15	16	17	18	D	16	17	18	19	20	D	20	21.5	22.5

Dimensions

	A	B	C(h ⁶)	D	E	F	G	H	J	K
FWC-300	495	139.7	139.719	171.45			25	M16	M42	M24
FWC-310	550	145	196.87	235	Flexible		35	M20	M42	M24
FWC-320	660	199.5	196.87	235			35	M20	M42	M24

Specifications

	Clamping Force (kgf)	Max. Drawbar Pull (kgf)	Jaw Stroke mm(dia)	Plunger Stroke (mm)	Wheel Size Range (inch)	Max. Speed (r.p.m.)	Weight (kg)	GD ² (kgf·m ²)
FWC-300	970	3000	27	35	12 ~ 18	2800	120	2.4
FWC-310	970	3000	27	35	13 ~ 20	2200	160	3.5
FWC-320	970	3000	27	35	17.5 ~ 24.5	1800	240	7.5

	Wheel Size											
	12"	13"	14"	15"	16"	17"	18"	19"	20"	21.5"	22.5"	
FWC-300	0	0	0	0	0	0	0					
FWC-310		0	0	0	0	0	0	0	0			
FWC-320						0	0	0	0	0	0	